

HOW TO ADJUST THE DEPTH OF A BLADE (ALL MODELS):

Move the red lever down to increase the blade depth, and up to reduce it. The blade depth locks in position automatically, by virtue of the cam the lever operates.

Tip: Very fine adjustments are easily possible with careful positioning of the lever – trial and error will teach this

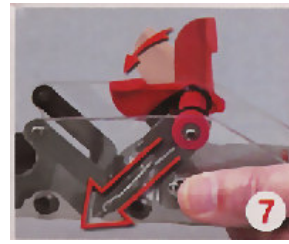

HOW TO CHANGE A BLADE (G03, RALI-Pocket, B30 MODELS):

Pull the red blade depth lever fully back



Raise the round locking bar up and into the top retaining slot



Using the red blade depth lever separate the blade holder and backing plate to reveal the old blade on its studs.
Remove and replace the blade as required – bevel edge downwards.
Close up the blade holder and backing plate to hold the blade loosely.



Drop the retaining bar down to the backing plate.
Position the blade sideways to suit your application.



Finally, push the locking bar into its retaining slot at the bottom.

Tip: The locking bar should click into place with a firm push. If it needs more than this, or won't locate at all, then the blade is not seated correctly. Open up and re-seat the blade.

