

### HOW TO ADJUST THE DEPTH OF A BLADE (ALL MODELS):

Move the red lever down to increase the blade depth, and up to reduce it. The blade depth locks in position automatically, by virtue of the cam the lever operates.

*Tip: Very fine adjustments are easily possible with careful positioning of the lever – trial and error will teach this*

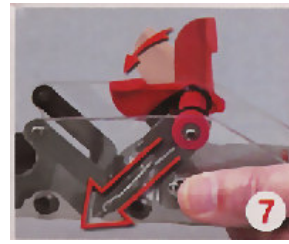

### HOW TO CHANGE A BLADE (RALI-Matic MODEL):

Pull the red blade depth lever as normal to raise the blade. Keep pulling the lever back to lift and separate the blade holder and backing plate.



Remove the old blade from the retaining pins, and fit new blade as required.



Push the backing plate down in contact with the blade and blade holder to lightly secure the blade.



Push the red blade depth lever down to move down and lock the blade mechanism ready for use.

